

# CKC

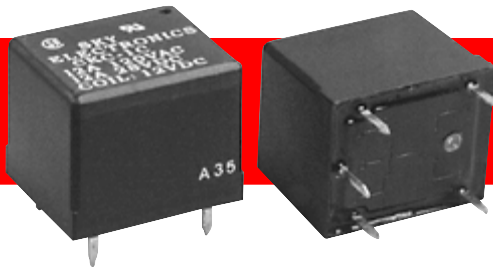

## CKC

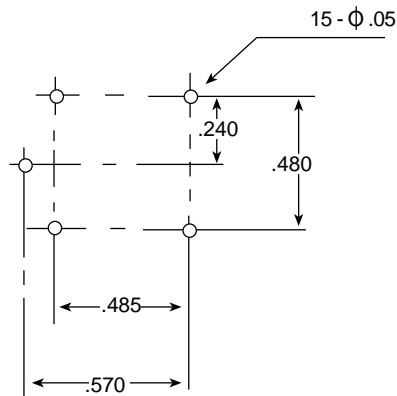
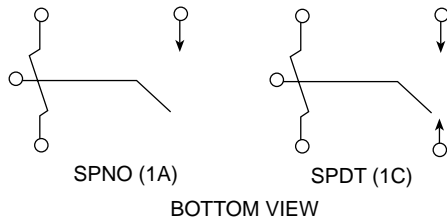
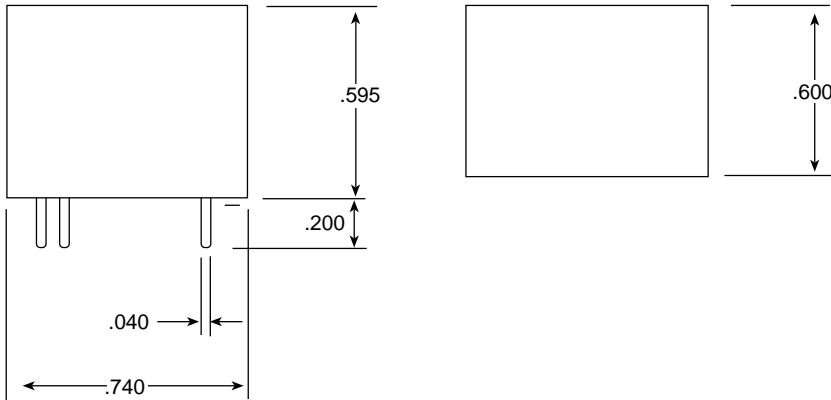

**5, 10 and 15 Ampere versions available...  
contact factory for details.**

## Reference Data

**Coil Temperature Rise**

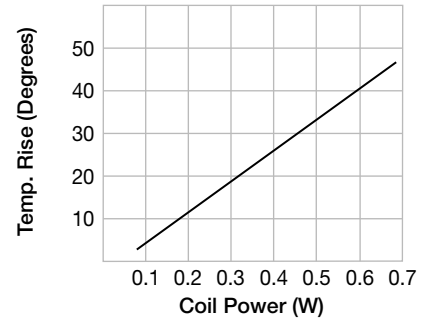

**Operate Time**

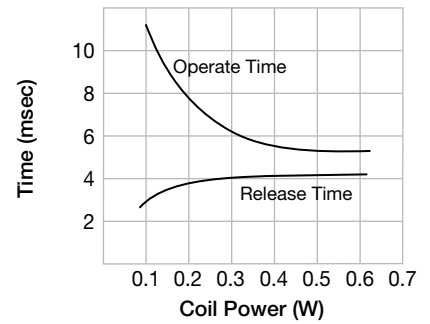

**Electrical Service Life**

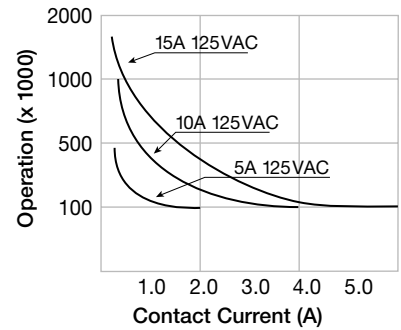

**Maximum Allowable Current**

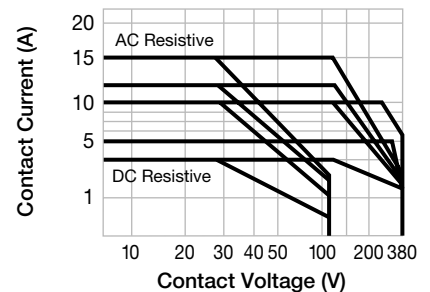

**CKC**

## Performance (At Initial Value)

ITEM	TYPE
	CKC
Contact Resistance	100 mΩ Max.
Operate Time	10 ms Max.
Release Time	5 ms Max.
Dielectric Strength: Between Coil and Contact Between Contacts	AC 1500 V 50 Hz (1 minute) AC 750 V 50 Hz (1 minute)
Surge Resistance	1000 V (between coil and contact 1x40 μ sec.)
Insulation Resistance	250 MΩ Min. (500 VDC)
Max. ON/OFF Switching: Mechanically Electrically	300 operations/min. 30 operations/min.
Operating Ambient Temperature	-55°C to 85°C
Operating Humidity	93% / 40°C
Coil Temperature Rise	See Chart
Vibration Endurance	10 to 55 Hz Dual Amplitude 1.5mm
Shock: Endurance Error Operation	10 G min. 5 G min.
Life Expectancy: Mechanically Electrically	10 <sup>7</sup> operations/min. (no load) 10 <sup>5</sup> operations/min. (at rated load)
Weight	About 9.5g

## Coil Specification (At 20°C)

TYPE	Nominal Voltage (VDC)	Nominal Current (mA)		Coil Resistance (Ω) ±10%		Must Operate Voltage (VDC) (Max)	Must Release Voltage (VDC) (Min)	Maximum Voltage (VDC)	Coil Power (W)
		5A, 10A	12A, 15A	5A, 10A	12A, 15A				
CKC	3	120	150	25	20	2.25	0.3	130% of Rated Voltage	0.36/0.45/0.80
	5	71	90	70	55.6	3.75	0.5		
	6	60	75	100	80	4.50	0.6		
	9	40	50	225	180	6.75	0.9		
	12	30	37.5	400	320	9.00	1.2		
	24	15	19	1600	1280	18.0	2.4		
	48	7.5	9.4	6400	5120	36.0	4.8		

## Contact Rating

ITEM	TYPE
	CKC
Contact Capacity Resistive Load (Cos. φ = 1) Inductive Load (Cos. φ = 0.4 L/R = 7 msec.)	See Chart See Chart
Rated Carrying Current	12 A
Max. Allowable Voltage	DC 110 V, AC 380 V
Max. Allowable Current	12 A
Contact Material	AgSnO <sub>2</sub>

## Ordering Information

**CKC 1C 12VDC**

**Coil Voltage**  
See coil specifications for available voltages. Other voltages available as special orders.

**Contact Configuration**  
1A – SPST; 1C – SPDT

UL #E96834(M) (U.S. &amp; Canada)

C.S.A. #LR83798-1